

GIPFEL FIGURE OF EIGHT DESCENDER

$10 \leq \text{Ø} \leq 12 \text{ mm}$
Rope (core + sheath) static, semi-static (EN 1891) or dynamic (EN 892)

This is a Type 2 braking device used for belaying and abseiling without a function to adjust the friction.

This descender conforms to EN15151-2 and UIAA 129 standards.

Individually tested!
PRODUCT CODE : BD100

PRICE

The product has to be checked once a year by qualified personnel. The following record must be filled in and kept with instruction booklet

PRODUCT NAME:.....	LOT#:.....					
MODEL NUMBER:						
DATE OF FIRST USE:						
MANUFACTURER:						
DATE OF PURCHASE:						
APPROVED ON (DATE)						
APPROVED BY						

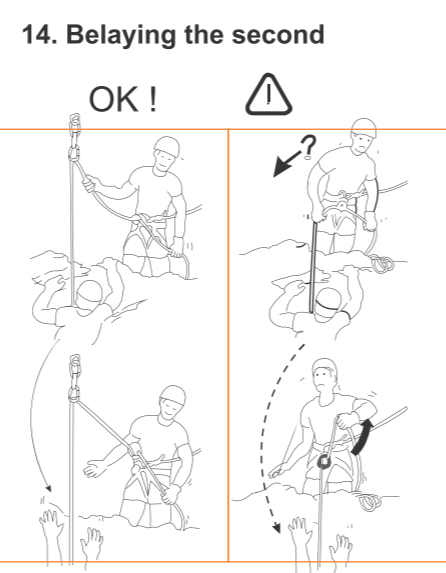
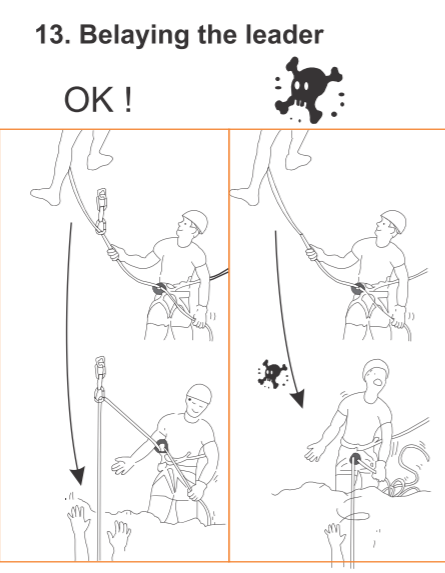
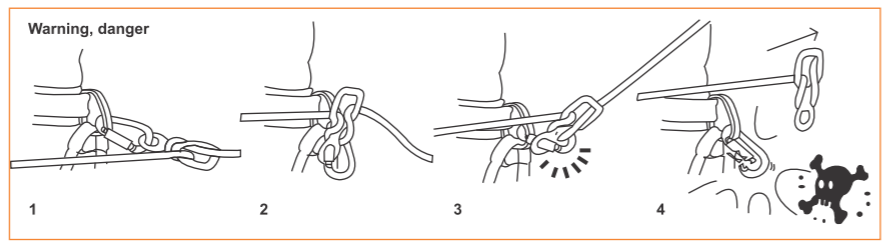
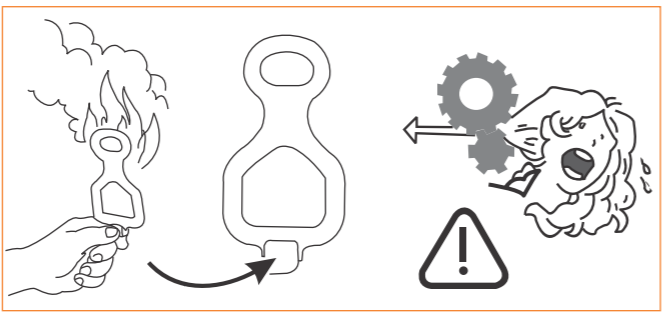
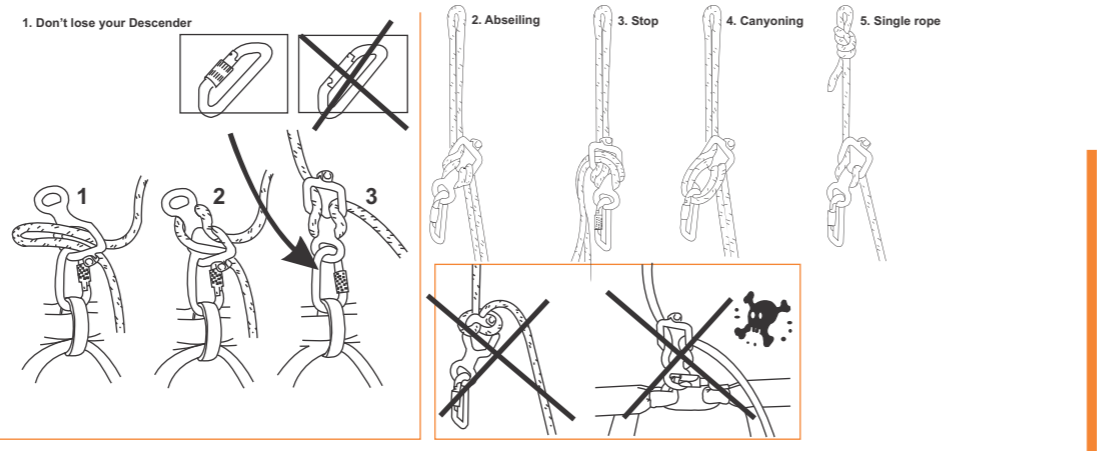
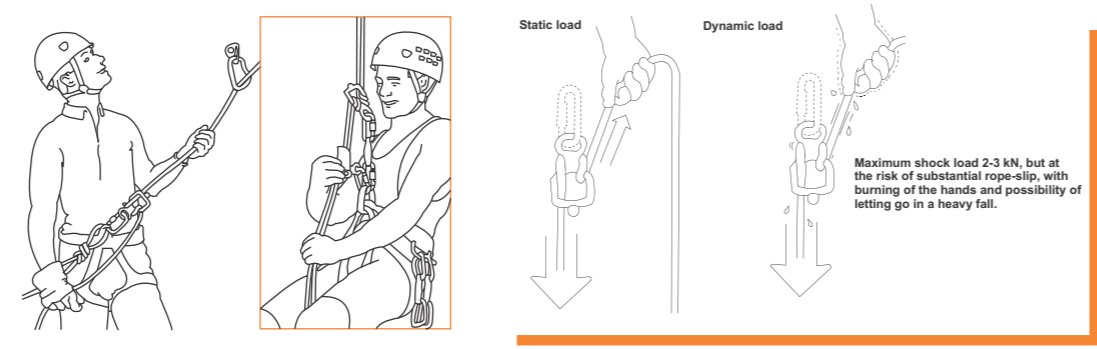
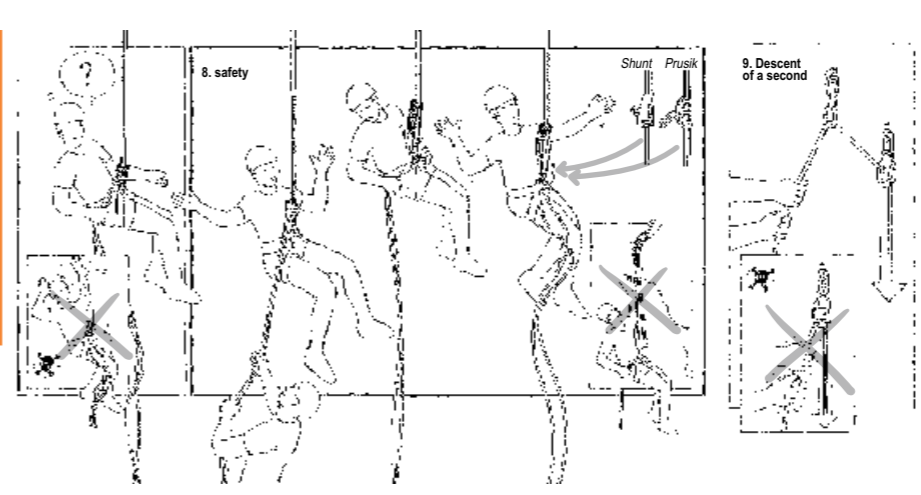
● 15. Recommended ● 16. Exceptional use requiring great experience

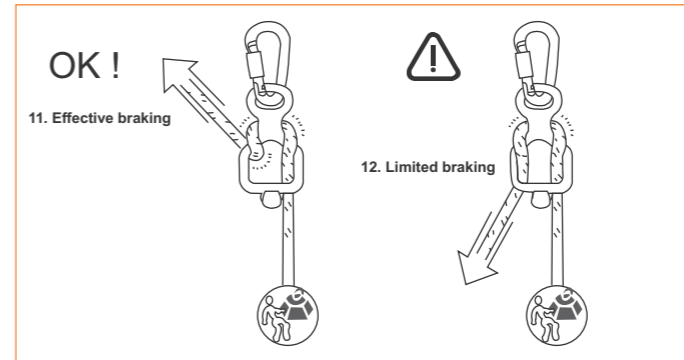

Guarantee
This product is guaranteed for 1 years against any fault in materials or manufacture. Exclusions from the guarantee: normal wear and tear, oxidation, modification or alteration, incorrect storage, poor maintenance, damage due to accidents, to negligence, or to improper or incorrect usage.

Responsibility
GIPFEL is not responsible for the consequence, direct, indirect or accidental, or any other type of damage befalling of resulting from the use of its products.

Meaning of Product Markings

- Danger! Incorrect technique!
- Warning. Pay attention!
- Correct technique!
- Recommended
- Read the instruction manual
- Limited effectiveness. Only recommended for experts.
- EN** European Standard

ENGLISH

For rock climbing and mountaineering use only. Climbing and mountaineering are dangerous. Understand and accept the risks involved before participating. You are responsible for your own action and decisions. Before using this product, read and understand all instruction and warnings that accompany it and familiarize yourself with its capabilities and limitations. We recommend that every climber seek proper training in the use of the equipment.

THIS EQUIPMENT CONFORMS TO EN15151-2 and UIAA129 . The conformity assessment for this equipment was done by notified body no. 1019.

THIS IS A TYPE 2 BRAKING DEVICE USED FOR BELAYING AND ABSEILING WITHOUT A FUNCTION TO ADJUST THE FRICTION. EFFECTIVENESS OF THIS BRAKING DEVICE DEPENDS ON THE ROPE DIAMETER (RECOMMENDED 11.5-12MM ROPE), SLIPPERINESS OF THE ROPE, DAMPNES OF THE ROPE AND ALSO ON THE SKILL LEVEL OF THE CLIMBER. IT IS THE RESPONSIBILITY OF EVERY USER TO FAMILIARIZE HIMSELF WITH THE BRAKING EFFECT IN A SAFE AND CONTROLLED ENVIRONMENT BEFORE THE ACTUAL USE.

THE FREE END OF THE ROPE SHALL BE CONTROLLED BY THE BRAKING HAND AT ALL TIMES!
INSTRUCTIONS FOR USE

Read this notice carefully and keep all instructions and information on the proper use and applications of the product(s). Only the technique shown in the diagrams that are not crossed out are authorized. All other uses are excluded: danger of death. A few examples of misuses and forbidden uses are also. Many other types of misuses exist and it is impossible to enumerate or even imagine all of them. In case of doubt or difficulty in understanding, contact GIPFEL.

You personally assume all risks and responsibility for all damage, injury or death which may occur during or following incorrect use of our product in any manner whatsoever. If you are not able, or not in a position to assume this responsibility or to take this risk, do not use this equipment.

This product must only be used by competent and responsible person, or those placed under the direct and visual control of a competent and responsible person. Personal protective equipment (PPE) is to be used only on or with energy absorbing system (for example dynamic ropes, energy absorbers, etc). Verify that this product is compatible with the other components of your system. See the instruction specific to the products. To prolong the life of this product, care is necessary, when transporting as well as when using it. Avoid impacts, or rubbing against abrasive surfaces or sharp edges.

MAJOR FALL AND IMPACT

Do not use this product after a major fall or a major impact (fall of the product or impact on the product). Even though no external signs may be visible, a deformation may restrict its operation or internal damage may have occurred, thus reducing its strength. Do not hesitate to contact GIPFEL in case of doubt.

SAFETY INSPECTION

Do not hesitate to retire a product showing signs of wear which might affect its strength, or restrict its operation.
-Before and after each use it is necessary to check the condition of the product.
-During use, it is important to regularly monitor the condition of the product and of its connections to the other elements of the system.
-A more thorough inspection must be carried out by a competent inspector (approximately every three months).

For more safety and better control of you equipment, we advise you to keep an "inspection record" for each product. It is preferable to personally issue each user of PPE with his or her own set of equipment. The Inspection Format could be downloaded from our website.

STORAGE AND AGEING

Maximum life time of this equipment is 2 years, taking into account the development of new techniques and the compatibility of products with our products.

This life time depends on the intensity, the frequency of use and the environment where the product is used.

- In exceptional circumstances, wear or damage could occur on the first use which reduces the lifetime of the product to that one single use.
- Certain environmental elements will considerably accelerate wear: salt, sand, snow, ice, moisture, chemicals, etc (list not exhaustive).
- Store only in corrosive free environment and from sharp objects. If the descender is found to have cracks or bends, do NOT use the product anymore.
- GIPFEL recommends these products undergo an in-depth inspection every 3 months.

If the check is passed, use is approved for another 3 months. If the test fails, retire the product immediately.

